

POLYPIPE RADIATOR TERMINAL PLATE



UK Registered Design Number 4008882

Patent Pending

POLYPLUMB POLYFIT



 Polypipe

POLYPIPE RADIATOR

Product Overview

The new Polypipe Radiator Terminal Plate is a multi functional product for use in Polyplumb and Polyfit piping systems.

- It provides an air tight seal around pipework entering rooms from wall cavities to feed radiators helping developers to achieve air tightness levels required by Building Regulations
- Gives a neat and secure entry point for pipes serving radiators
- Ensures pipes are not damaged by rough edges of wall boards or plaster boards
- Can be fitted with or without a single gang electrical back box (supplied by others)

Product Features

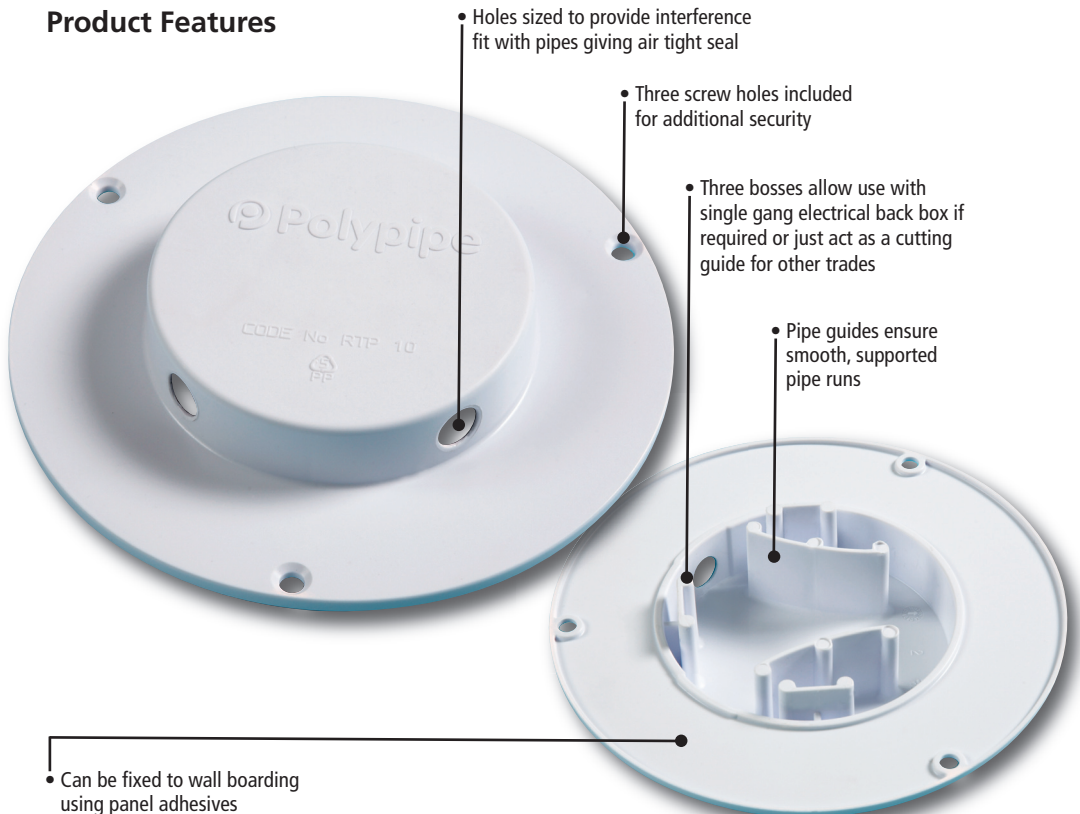

TERMINAL PLATE

Installation Guidance

STEP BY STEP INSTALLATION INSTRUCTIONS

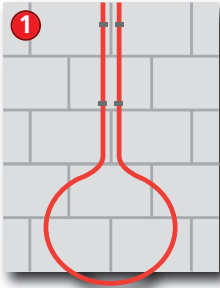

1 Install 10mm flow and return pipework down sub-wall with continuous loop long enough for radiator feeds through wall. Pressure testing of heating system is recommended at this stage.

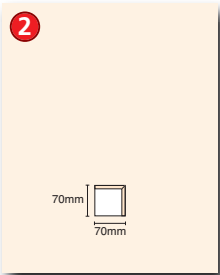

2 Cut a hole the size of a standard single gang electrical back box in the wall boarding. For guidance use the three bosses on the reverse side of the Polypipe Radiator Terminal Plate.

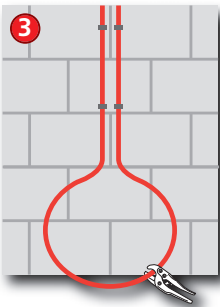

3 Cut pipes at appropriate point to allow for wall board to be installed ensuring enough pipe is left to reach valves at each end of radiator.

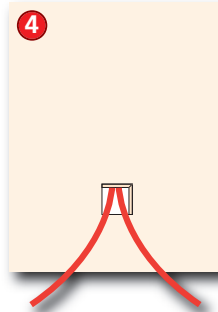

4 Thread pipes through hole cut in wall board taking care not to scratch or damage pipes.

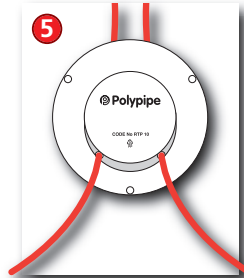

5 Pass the pipes through the radiator terminal plate from back to front using the pipe guides to aid routing. They should be a tight interference fit through the holes which provides the seal. Cutting the ends of the pipes at an angle may help to thread pipes through the hole but remember to cut pipes square again before connecting into a fitting.

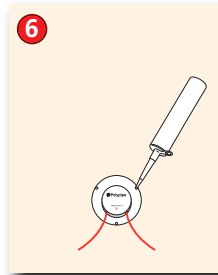

6 Use panel adhesive to seal the Polypipe Radiator Terminal Plate to the wall board and if necessary use tape or three countersunk screws to hold the plate in position whilst the adhesive sets.

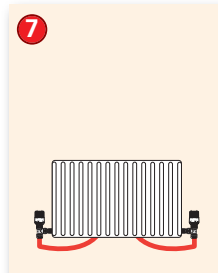

7 Fit radiator and valves and connect the pipes as per normal installation instructions.

Ordering Information

Product description:

Polypipe Radiator Terminal Plate



Product code: **RTP10**

TPL: **£5.99** each Pack quantity: **10**

Polypipe Building Products

Broomhouse Lane, Edlington, Doncaster, DN12 1ES

Telephone: 01709 770 000 Fax: 01709 770 001

